

Member FDIC

COMMUNITY. BANKING.

SUPPORTING OUR COMMUNITY SINCE 1875.



Guilford Savings Bank

Your Community. Your Values. Your Bank.

gsb-yourbank.com/giving-back

Shoreline Eldercare Alliance - GSB is proud to be part of
YOUR COMMUNITY.

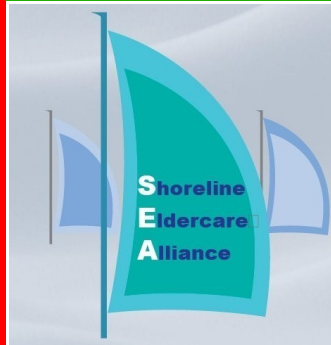

**Celebrating
10 years of
providing education
to the Shoreline
Senior Community**

10th Annual Celebration of Healthy Aging

Remembering the PAST

Celebrating the PRESENT

Looking forward to the FUTURE

Wednesday, May 22, 2019

10:00 M - 3:30 PM

Woodwinds

29 School Ground Road, Branford, CT

RWVC LLC

ATTORNEYS & COUNSELORS AT LAW
The Personal Touch Your Most Important Decisions Deserve

Elder Law
Title 19/Medicaid
VA Aid & Attendance
Estate Planning/Wills
Conservatorships
Powers of Attorney
Advance Healthcare Directives
Estate and Trust Administration
Estate Tax Returns
Probate



Joan Reed Wilson, Esq.
Managing Partner
Board Member, Shoreline Eldercare Alliance

COMPASSIONATE
KNOWLEDGEABLE
DEDICATED

MIDDLETOWN CLINTON NORTH HAVEN

860-669-1222 | www.reedwilsoncase.com

Assisted Living SERVICES, INC.

IN-HOME CARE SOLUTIONS FOR AGING IN PLACE



Quality Homecare for Seniors

24 Hour
Live-In
Services

Hourly
Personal Care
Assistants

Homemakers
and
Companions

Adult Family
Living
Program

Care Plus
Technology
& Services

833-634-8668

www.assistedlivingct.com

CT. Reg. #0000124

NOTES

HISTORY OF SHORELINE ELDERCARE ALLIANCE

Twelve years ago, Holly Warner (now with Masonic Health Systems) and Bernadette DiGiulian (Geriatric Care Manager) would frequently meet professionally. They discussed their concerns that the seniors they cared for were very negative about growing older and had little knowledge about healthy aging. Holly and Bernadette wanted to change people's attitudes and put a more positive spin on growing older in a healthy way. They decided to form a group that would educate seniors toward healthy aging.

A small group of professionals, all interested in and committed to educating seniors began to meet monthly. They called themselves the Shoreline Eldercare Alliance (SEA) and for over a year, their meetings covered ways their professions could help seniors as they aged. They also educated each other about issues that pertained to senior health. These original members included Bernadette DiGiulian, Holly Warner, Jean Cherni, Barbara Katz, Christine Bailey, Jonathan Snyder, Mark Connell, Debra Laudano, and Karen Ragonese.

Ten years ago, SEA took a big leap and with the help of Debra Laudano (then of the Village at Mariner's Point) sponsored their first signature educational event, "A Celebration of Healthy Aging." It was hosted by the Village at Mariner's Point, a venue that SEA thought would bring many seniors together to celebrate the pride of growing older in a healthy manner. SEA also brought senior music, dance and singing groups to showcase seniors living active and full lives. This first event brought 300 seniors together.

At this first Celebration of Healthy Aging, Dr. Gerard Kerins was SEA's keynote speaker. Ten years later, Dr. Kerins is again our keynote speaker and will speak about senior care and attitudes ten years ago, at present, and what he hopes for the future. After three years at The Village at Mariner's Point, SEA moved the celebration to the Owenego Beach and Tennis Club, a beautiful venue on Long Island Sound. Today, we celebrate at Woodwinds in Branford, where SEA has been since 2016.

Today, SEA is proud to have thirty dedicated members, representing many types of senior care. Look at our brochure and program to see who our members are and the many services they provide. SEA holds educational sessions about healthy aging throughout the year, speaks before other service groups, is represented at health fairs and other festivals along the shoreline and continues to sponsor this event, "A Celebration of Healthy Aging." SEA is proud of its members, its growth, and the impact SEA has made over the last ten years. SEA has confirmed our belief that many seniors are interested in being educated and want to plan for healthy aging. We think SEA is part of that success!

On our tenth anniversary, we look forward to continuing to serve our shoreline communities with outstanding educational programming and look forward to helping advance healthy aging. We hope you will join us.

Today's Schedule of Events

10:00 a.m.- 12:00 p.m. – The Wellness Room is open. You are welcome to return at any time including lunchtime.

(Closed during Keynote Speaker Presentation)

Our Wellness Room gives you many possibilities of services that you or your clients can use today or in the future. SEA encourages seniors to be well informed about choices and options and we try to provide information to help you with important decisions.

Enjoy Senior Massage or Seated Tai Chi on the patio off the Fireside Room

Senior Massage is gentle touch to relax muscle tension and sooth chronic pain. It creates calm, relieves anxiety, helps improve sleep, brings relaxation, and more.

Tai Chi in a Chair is a gentle graceful form of exercise that's been practiced for 2,000 years. Tai chi improves wellness and awareness and may promote healing.

10:45 11:45 a.m. & 12:45 - 1p.m. —The Survivors Swing Band offers music in the main dining room

11:45 a.m. – Introductions –

Bernadette DiGiulian & Guilford Savings Bank,

**Introduction of SEA members by
SEA President Janet Woxland**

Hungry? Appetizers are served pre-lunch

Lunch is buffet-style at 12:45 p.m.

NOTES

We hope you use this program as a reference.

**As you need information or help, remember
to call us at 1-800-426-5086**

or email us at:

info@shorelineeldercarealliance.org

**Thank you for attending our 10th annual
Celebration of Healthy Aging!**

**Be sure to get on our email list
to receive notifications of our excellent presentations
throughout the year.**

**We look forward to seeing you at our
11th year celebration.**

Wishing you Healthy Aging!!!

Today's Schedule of Events (cont.)

12:00 a.m. - Keynote speaker:

Dr. Gerard Kerins

*Yesterday, Today and Tomorrow -
A Look at Seniors and Senior Care*

12:45 – Lunch served buffet-style

Please wait for your Table # to be called!

12:45-2:00—Wellness Room reopens

Lunchtime Entertainment

1:00 – 1:20

Branford High School Music Makers

1:20 – 1:35

Guilford Aerobic Group

1:35 – 1:50

Branford Senior Center Tappers

**1:50 – 2:00 The Survivors Swing Band ends
with a sing along**

2:00—Joyce Saltman

10 Best Ways to Preserve Your Humor

We thank Joyce for her many years of helping us to
enjoy laughing...a gateway to healthy aging!

**3:00 - Closing Remarks and drawing of
3 lucky winners!**

**Enjoy a FREE soft drink at Woodwinds
Cash Bar open 11:30 AM– 3:00 P.M.**

**Keynote Speaker:
Dr. Gerard J. Kerins**

Dr. Kerins is the Associate Chief of Geriatrics for Education at Yale New Haven Hospital and Yale Medical School. In addition, he is the Program Director for the Geriatric Medicine Fellowship and an Associate Clinical Professor of Medicine at the Yale School of Medicine as well as the University of Connecticut, School of Medicine. Dr. Kerins is a member of the State of Connecticut Office of Protection and Advocacy for Persons with Disabilities Fatality Review Board. He serves as a consultant to the State of Connecticut Disability Center and the State of Connecticut Department of Developmental Services. He is also a member of the Scientific Advisory Committee of the Connecticut Alzheimer Association.

Dr. Kerins is board-certified in Geriatrics and is a Fellow of the American College of Physicians. Clinical areas of interest and research include geriatric assessment, Alzheimer's disease, and the care of older adults with Down syndrome.



Joyce Saltman

Joyce Saltman is a professor Emeritus of Special Education at Southern Connecticut State University in New Haven. She chose to receive her doctoral degree from Columbia, because she loved the color of their doctoral gown. It was no small feat that she was able to persuade her mentor to allow her to write her dissertation on "Humor in Adult Learning."

She also holds four graduate degrees in the fields of Special Education and Counseling. Joyce's innovative teaching style has led to the development of a graduate course entitled, "The Enhancement of Learning Through Humor," as well as a summer institute called, "Healing, Education Laughter and Play (HELP)." Her experience in the areas of education, therapy, and comedy has provided an outstanding background for her research on "The Therapeutic Value of Laughter." Since 1983, when Joyce began lecturing on "Laughter," she has been interviewed by national radio and TV. Her dynamic seminars and articles, always peppered with humor,

address such topic as dealing with difficult people, laughter as therapy, parenting, and relationships. Her goal is to enlighten, educate, and entertain while the audience laughs. Joyce has been speaking on "Laughter" and related uplifting topics and hopes to be able to die laughing - but not too soon!!! Joyce is the 2015 recipient of the Doug Fletcher Lifetime Achievement Award from the Association for the Applied and Therapeutic Humor (AATH).



Please support these generous contributors

Gifts in Kind 2019

Dr. Gerard Kerins- Geriatrician, Keynote Speaker

Joyce Saltman- Humorist, Educator

Mardyann Goglia and the Branford Tappers

Barbara Corso and the Guilford Aerobics Group

Mike Martone & The Branford High School

Music Makers

Woodwinds: Today's Lunch

VNA Community Health Care

Shore Publishing

Happy Days Vending and Rentals-Guilford

Chris Hauman Webbersaur.u.s.-website designer

Myers Florist-Branford

For Goodness Cakes with appreciation for the 10

year anniversary cupcakes - Rebecca Cudgma

Leo Cristofar and David Engler - Chair Massage

Suzanne Hanley and Alanna Keating - Tai Chi

Special Thanks to: K & G Graphics for their ten years of contributions and support of SEA and for their printing this program and signage for today's Celebration of Healthy Aging.

Special Thanks to: Christine Bailey, geriatric researcher, artist and founder- Colorful Chronicles: Preserving the Memories, for her graphic design of SEA's programs throughout the years.

Please support these generous contributors

Friends of SEA 2019

Terry Architecture LLC - Branford
Audiology Concierge - Old Saybrook
Norman Chonacky and Jane Jervis - New Haven
Leo Cristofar - Branford
David DeLancy—Home Instead Senior Care of
Guilford
Mimi Franklin - Ballina, County Mayo, Ireland
Louise Lamontagne - Branford
Attorney Donna Levine - Elder Law - North Haven
Jill Martin - Hamden
Norman Needleman –
Tower Laboratories, Ltd.—Centerbrook
North Branford Dental Group PC
Sandra and Bill Rueb of Old Lyme
Senior Bridge/Humana at Home – Madison
Synergy Homecare
Tower One/Tower East- New Haven
Towne Pharmacy—Branford
Joyce and Dr. Vincent Quiglierio—North Haven
Virginia and John Wilkinson, New Haven

***Please support these generous
contributors to SEA***

Dessert Contributors:

Cheri's Bakery – Branford
La Cuisine – Branford
P&M Deli – Branford
Parthenon Diner – Branford
Petonito's – East Haven
Take the Cake – Guilford

And our members who also donated desserts:

Artis Senior Living- Branford
Audiology Concierge– Old Saybrook
Branford Hills Health Care Center – Branford
Connecticut Hospice – Branford
Elder Caring LLC, Geriatric Care Management-
Branford
Orchard House Medical Day Care-Branford
The Village at Mariner's Point – East Haven
The Hearth at Gardenside - Branford
The Hearth at Tuxis Pond– Madison
Tower One/Tower East – New Haven

2019 Main Sponsor Tables

Guilford Savings Bank - Event Sponsor
Assisted Living Services, Inc. - Gold Sponsor
RWC LLC — Attorneys at Law - Gold Sponsor
Artis Senior Living—Valet Sponsor
Yale New Haven Health Systems - Silver Sponsor
Branford Hills Health Care Center - Silver Sponsor
Guilford Radiology—Bronze Sponsor
Widex - Bronze Sponsor

2019 The Wellness Room

Relaxation, Learning, Interactive & Informative

AAA Northeast
Alzheimer's Association - CT Chapter
Anthem Blue Cross Blue Shield
Audiology Concierge
Branford Hills Health Care Center
Brian Cobb—Independent Insurance Producer
CapTel Outreach
Comfort Keepers of Guilford
Connecticut Hospice
David Engler & Leo Cristofar (Chair Massage)
Suzanne Hanley and Alanna Keating (Seated Tai Chi)
Estate Solutions
Great Plains Senior Veterans
Hilltop Gallery
Joint Effort
Just So Organized
Dr. Karen P. Gallo, Family Dentistry
Lifetime Care @ Home
Mary Wade

Deborah Vezan
President/Founder

25 Joshuatown Road
Lyme, CT 06371
ph: 860.304.3250
dvezan@limbkeepers.com

limbkeepers.com



**Non-compression Protective
Sleeves & Gloves**



Joyce E. Martinelli
Community Liaison
jmartinelli@theorchardhouse.org



421 Shore Drive
Branford, CT. 06405
203.481.7110 phone
203.481.2064 fax
www.theorchardhouse.org



**TWO MEN
AND A
TRUCK.**

Stephen Menyfield
Sales Development Director
stephen.menyfield@twomen.com

HG1775
U.S. DOT No. 2467664

60 Belamose Avenue Unit A-3
Rocky Hill, CT 06067
p 860.724.2901

458 Grand Avenue
New Haven, CT 06513
p 203.836.2217

twomen.com



Bernadette DiGiulian, M.Div.
Geriatric Care Manager

Elder Caring LLC

FOR LIFE'S DECISION MAKING & PLANNING

SHORELINE INSURANCE
SERVICES INC



Steven Cudgma, CLTC
steven.cudgma@shorelineinsurancect.com
203-988-4137
Serving the Shoreline for
Medicare - Small Group
Individual Health Plans
Life & Disability - Long Term Care
Access Health Ct Authorized Broker

DAVID B. DZIURA D.C.FACO DACBOH

Chiropractic Physician

Phone (203) 481-6150
Fax (203) 481-0411
E-Mail: ddziurachiro@aol.com

650 Main Street
Branford, CT 06405



DAVID C. MINICOZZI
GENERAL PRACTICE OF LAW

250 West Main Street, Suite 200
Branford, CT 06405
attyminicozzi@gmail.com

Office (203) 483-7069
Mobile (203) 804-0841
Fax (203) 483-7428

www.attydave.com

Lisa Bonnanzio-Piasecki

Owner-Designer

Flowers by Lisa
Flowers Of Distinction

203-468-6151
flowersbylisap.com
flowersbylisa@att.net

33 Hemingway Avenue
East Haven, CT 06512

2019 The Wellness Room

Relaxation, Learning, Interactive and Informative

Masonicare
McKinstry Financial & Investments LLC
Mind Matters
New England Stairlifts
Orchard House Medical Adult Day Care Center
Personal Touch Organizers
Premiere Concierge CT
Real Living Real Estate
Senior Blue Book
Senior Bridge Humana at Home
Shoreline Aging In Place
Shoreline Insurance Services, Inc.
Shoreline of Clinton
Stop & Shop—PEAPOD
Strong House
Swan Funeral Home
Towne Pharmacy
The Towers
United Healthcare
Village at Mariner's Point
VA Benefits
VNA Community Healthcare & Hospice
W.S Clancy Memorial Funeral Home

Remember to visit all the exhibitors and get checked off as having visited to be eligible to win a prize. Put your card in the box when leaving the wellness room. Three names will be picked (3:00 PM) and prizes will be given !!!

SEA - Members and Contact Information

Artis Senior Living—Sharelle Thornton, Lead Director Community Relations & Stephanie Evans-Aiker - Executive Director

Sthornton@ArtisMgmt.com - Sevans@ArtisMgmt.com 203-859-1784

Assisted Living Services/Assisted Living Technologies -

Mary Scagliarini RN - Director Adult Family Living Program

Mary@assistedlivingct.com 203-634-8668

Audiology Concierge- Nancy Jablonski M.S.—Audiologist &

Rene Vicedomini H.I.S. - Hearing Instrument Specialist

njablonski@audiologyconcierge.com - Renevicedomini@yahoo.com

Nancy 203-668-0618 Rene 985-246-9737

Branford Hills Health Care Center

Janet Woxland— Administrator

jwoxland@bhcc.com 203-483-4467

Cartier & Bower LLC. Cynthia Cartier & Raymond Bower

Elder and Family Attorneys

ccartier@cartierbower.com - rbower@cartierbower.com 203-458-1477

The Connecticut Hospice

Linda Laucella—Manager -Development

llaucella@hospice.com 203-315-7684

Elder Caring LLC Bernadette DiGuilian—Geriatric Care Manager

BPDiguil@aol.com 203-214--0928

Karen Gallo, DMD - General Dentist

officegallo@yahoo.com 203-467-3333

Guilford Savings Bank Sylvia Patterson & Kathleen Duncan – Reverse Mortgage Specialists

SPatterson@GSByourbank.com

Sylvia 203- 458-5414

KDuncan@GSByourbank.com

Kathleen 203-458-5422

The Hearth at Tuxis Pond—Debbie Battista & Tim Holder

dbattista@thehearthllc.net - tholder@thehearthllc.net 203-215-7100

Joint Effort - George Norden

jointeffortexercise@gmail.com 475-221-8095

Madison Senior Center - Austin Hall - Administrator

Halla@madisonct.org 203-245-5685

The *Hearth* at Tuxis Pond

Premier Senior Living & Memory Care

MARCIA L. TURNER, PDMM., CSA
Y.E.A., LLC

PO Box 584
North Branford, CT 06471

mlturnerpdmm@outlook.com
Phone 203-671-1923



Confidential, Personalized Professional Services; Bill Paying, Organize & Maintain Bank Records, Computer recordkeeping, General Organizational Support, Notary, Member Shoreline Eldercare Alliance

Independent
Insurance
Producer

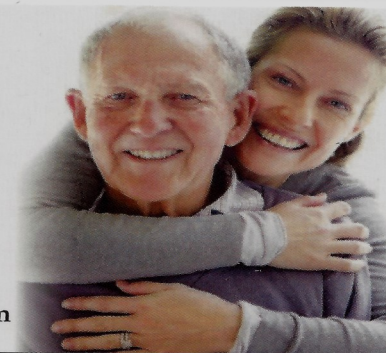

Brian Cobb
2 Madison Avenue
Shelton, CT 06484
Tel: 203-913-2909
bcobb6031987@gmail.com



Gracious Living for Mom & Dad.
Peace of Mind for You.

Independent Living • Assisted Living
Safe Harbor Memory Care

860-345-3779

TheSaybrookAtHaddam.com.

WHEELCHAIR SERVICE
203-506-8294



KAYBELLA
TRANSPORTATION



Kim Kelly-Rubin
Director of Community Relations
kkellyrubin@benchmarkquality.com

111 South Shore Drive
East Haven, CT 06512
www.villageatmarinerspoint.com

P: 203-467-0067
C: 203-804-4541
F: 203-467-3748

Dr. Karen P. Gallo D.M.D.

35 High Street East Haven, CT 06512



(203)467-3333

karenpgallo@md.com



\$15.00 OFF
Any Service!

Coupon must be presented at time of service
and cannot be combined with any other offers.

1250 Boston Post Rd. | Guilford, CT 06437
P: (203) 458-3200

WWW.NERDSTOGO.COM

SEA - Members and Contact Information

Marcia L. Turner—Daily Money Management Services, YEA LLC
Mlturnerpdmm@outlook.com 203-671-1923

Orchard House Medical Adult Day Care

Ellen Carucci - Executive Director
ecarucci@theorchardhouse.org 203-481-7110

Real Living Real Estate— SRES, Senior Real Estate Specialist

Greg Robbins
ggrobbins@gmail.com 203-787-7800

RWC, LLC

Joan Reed Wilson , Esquire—Attorneys & Counselors at Law
jwilson@reedwilsoncase.com 860-669-1222

Seasons Hospice & Palliative Care -

Andie Mackey & Alison Kowalski , Hospice Care Consultants
amackey@seasons.org akowalski@seasons.org (203) 490-1000

Senior Bridge— Humana at Home -

Lilian Ciesco, Business Executive Christina Bertelle, Clinical Manager
lciesco@seniorbridge.com cbertelle@seniorbridge.com 203-233-0470

Shoreline Insurance Services Inc.

Steven P. Cudgma, CLTC Certified Medicare Specialist
Steven.cudgma@shorelineinsurancect.com 203-988-4137

Towne Pharmacy -

Vincent Ragonese - Medical Equipment Specialist
Karen Ragonese - Pharmacist
Vincent.ragonese@snet.net 203-488-1631

The Towers

Rebecca Goodman-Olshansky - Occupancy/Marketing Specialist
Rebecca@towerone.org 203-772-1816

The Village at Mariners Point –

Kim Kelly-Rubin
kkellyrubin@benchmarkquality.com 203-467-0067

VNA Community Health Care & Hospice - Barbara Katz,

Clinical Program Development & Edward Zambrello, Community Outreach
Bkatz@vna-commh.org; Ezambrello@vna-commh.org 203-458-4200

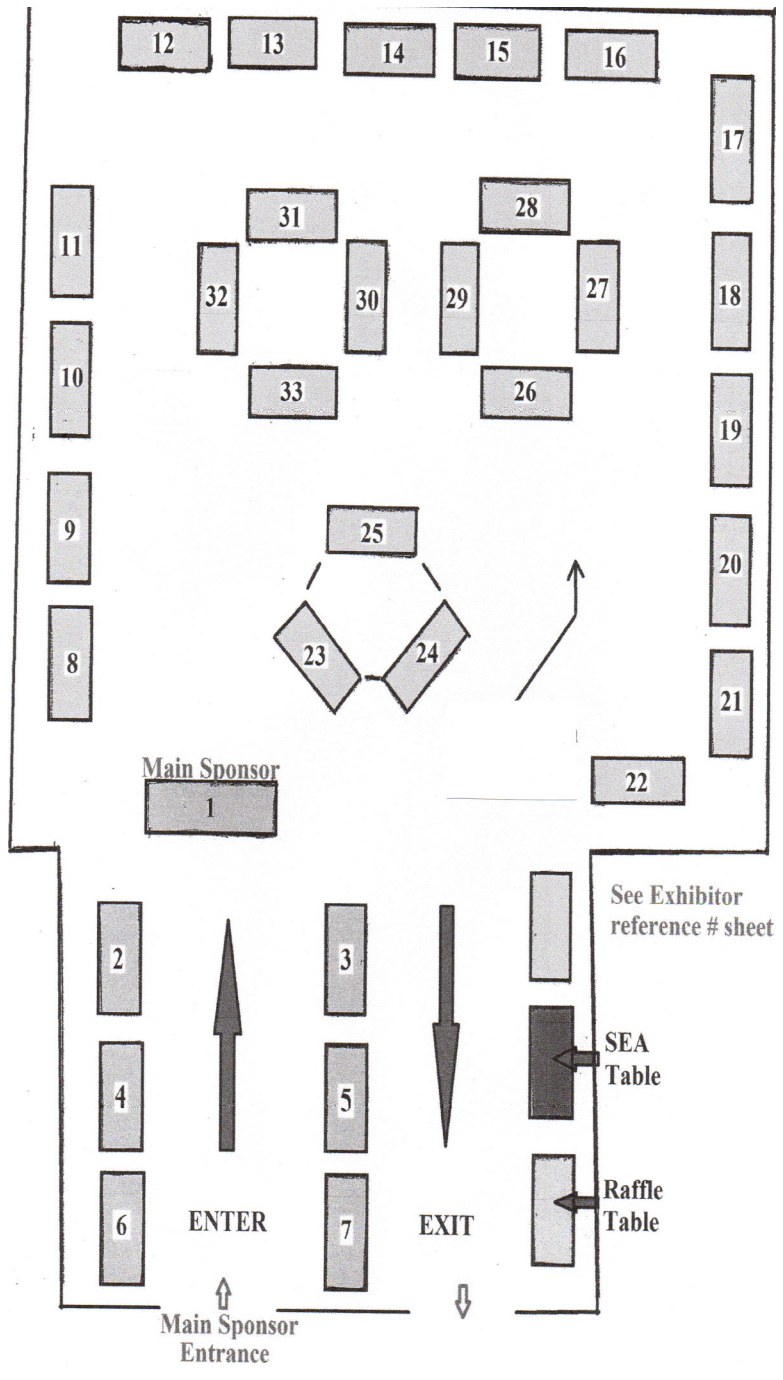

Yale NewHaven Health

SHARELLE THORNTON
Lead Director of Community Relations



814 East Main Street
Branford, CT 06405

Main 203.533.7287
Fax 203.689.5977
Cell 203.859.1784

SThornton@Artismgmt.com
www.artis seniorliving.com

Creating positive partnerships the Artis way



**Branford Hills
Health Care Center**
Your Path To Well Being

- Physical/Occupational
- Speech/Respiratory Therapy
- 24-Hour Nursing Care
- Recreational Programs
- On-Site Pharmacy
- Outpatient Therapy



189 Alps Road Branford, CT 06405

Five-Star Quality Rated
by Centers for Medicare and Medicaid Services

203-315-2642
www.bhhcc.com



Guilford Savings Bank
Your Community. Your Values. Your Bank.

Kathleen Duncan

AVP, Reverse Mortgage Specialist
NMLS# 844014

61 North Main Street • Branford, CT 06405
Phone (203) 458-5422 • Cell (203) 800-1165
KDuncan@GSByourbank.com

gsb-yourbank.com gsb-yourbank.com/kathy

AUDIOLOGY Concierge™

EMPOWERING LIVES THROUGH BETTER HEARING

René Vicedomini, H.I.S.
Hearing Instrument Specialist

985.246.9737
rvicedomini@audiologyconcierge.com

Nancy Jablonski, M.S., F-AAA
Audiologist

203.668.0619
njablonski@audiologyconcierge.com

www.audiologyconcierge.com

CompassionateCARE



Guardian Angels
HOMECARE

Mary Ellen Leviness
Care Manager

C 203-360-8871
maryellen@compassionatect.com

David Laughran
Financial Advisor

Edward Jones
MAKING SENSE OF INVESTING

158 Montowese Street
Branford, CT 06405
Bus. 203-483-6636 Fax 888-318-1581
Cell 203-376-2208
david.laughran@edwardjones.com
www.edwardjones.com



THE SHREDDING SOURCE
SECURE INFORMATION DESTRUCTION BY BONDED PROFESSIONALS
HARD DRIVES DOCUMENTS COMPUTER RECYCLING



Trish Denison - Sales Manager

Office- (203) 458-7667 Cell- (203) 671-0162
trishdenison@shreddingsource.com

Table #	Exhibitor
1	Guilford Savings Bank
2	Assisted Living Services/Technologies
3	RWC, LLC
4	Branford Hills Health Care Center
5	Artis Senior Living of Branford
6	Yale New Haven Health Systems
7	Guilford Radiology
8	McKinstry Financial
9	Orchard House/ Joint Effort
10	Premier Concierge CT/Senior Blue Book
11	Branford Hills Health Care Blood Pressure Check
12	New England Stairlift and Bath
13	Just So Organized/Personal Touch Organizers
14	Connecticut Hospice/Strong House
15	VNA Community Health/Lifetime Care @ Home
16	The Towers/Senior Bridge-Humana
17	Free Information
18	Shoreline of Clinton/Stop & Shop Peapod
19	Estate Solutions of CT/Hilltop Gallery
20	Real Living Real Estate/Towne Pharmacy
21	Comfort Keepers/AAA Northeast
22	Mind Matters/Great Plains Senior Veterans
23	Swan Funeral Home
24	Shoreline Insurance /The Village at Mariners Point
25	Alzheimers Association of CT
26	Masonicare/Brian Cobb Individual
27	United Health Care
28	Mary Wade
29	W.S. Clancy Memorial Funeral Home
30	Shoreline Aging In Place
31	Captel
32	Karen Gallo DMD/Audiology Concierge
33	Anthem Blue Cross & Blue Shield

Thanks to our Sponsors

Main Event Sponsor



Gold Sponsors



Valet Sponsor



Thanks to our Sponsors

Silver Sponsors



**Branford Hills
Health Care Center**



Bronze Sponsors

